



OUR MISSION: Provide essential value to our members and partners, advance Civil Engineering, and serve the public good.

News & Updates - March 11, 2025 | Volume 55, Number 3



- **Mid-Atlantic East ASCE Student Symposium hosted by Penn State University Park - March 28-29, 2025**
- **April Dinner Meeting - Structures: See Save the Date info below. This event also honors our members attaining Life Membership in ASCE.**
- **Annual Harrisburg Senators Game and Picnic - May 9, 2025**

[Central PA Section Events Link](#)

**ASCE NEEDS VOLUNTEERS
LIKE YOU!**

**Please consider joining the ASCE
Central PA Section Board by contacting**



**Loujin Daher at
*centralpa.asce@gmail.com***

**Open Board Positions Include:
*Program Chair
Government Relations Chair
Member of Various Committees***

President's Message

Save the Date – April 16, 2025 Dinner Meeting Presentation

The Bridge State of the State - Presented by Kristen Langer, PE, PennDOT's Chief Bridge Engineer

Please join ASCE Central PA on April 16th at the Penn Harris Hotel for a dinner meeting presentation by PennDOT's Chief Bridge Engineer Kristen Langer, PE. She will be presenting on the latest bridge resiliency initiatives, recent updates on PennDOT's bridge inspection guidelines, the latest updates to the bridge design and construction standards, along with newly approved bridge products and recent research. She will also provide an overview of her experience, and philosophy on the future direction of PennDOT's Bureau of Bridge.



Click [HERE](#) for more information on the 2025 Convention.

ASCE's State Report Card Program

ASCE's state report card program is an excellent way for engineers to learn the basics of government and infrastructure policies affecting their projects. When you volunteer with your state's report card, ASCE Government Relations staff helps guide you through the report card process along with training to help tell the story of your state's infrastructure to the public, media, and government officials. There are also built-in opportunities to network with colleagues in the public and private sectors.

Please email reportcard@asce.org to inquire about joining a state report card committee.

Annual Section Hershey Bears Game Outing

On Saturday December 14th, the Central Pennsylvania Section's Younger Member Group (YMG) hosted its annual Section Hershey Bears Game Hockey Outing at the Giant Center in Hershey, PA. Click [HERE](#) for the full article.



On Wednesday February 12th, the Section welcomed Steven Metzler, P.E., Senior Engineering Project Manager in York Water Company's Engineering Department and Ethan Miller, P.E., Project Engineer in Gannett Fleming TranSystems' Geotechnical, Dams, & Hydraulics Section to give an in-person dinner meeting presentation on the recently completed and award winning Lake Williams Dam Rehabilitation Project. Click [HERE](#) to read the full article.



As ASCE looks ahead to its 175th anniversary, plans are in the works for a large conference and expo to debut in 2027. The event would consolidate many of the organization's various institute annual conferences into a single-tent offering for all who work in the architecture, engineering, and construction industry.

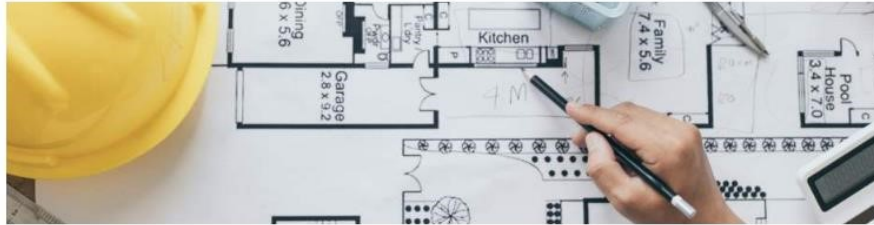

The Region 2 Ally is the Region 2 Newsletter, intended to empower Region 2 members with news and connections across the Region, Society, and our profession. We are your ally in the industry. Visit Region 2 online for information about the board, events, and awards as well as other useful resources.

Vision

Region 2 is an inclusive community of members who are actively engaged in advancing the profession.

Mission

Region 2 supports all levels of the organization and its members by facilitating engagement opportunities to share knowledge and resources through peer-to-peer relationships.

Meet your Governors

The Region 2 Board of Governors meets monthly.

- Carol C. Martsof, P.E., F.ASCE (Director)
- John Caperilla, AM.ASCE
- Greg Kuklinski, P.E., F.ASCE
- Michelle Madzellan, P.E., F.ASCE
- Joe Platt, P.E., M.ASCE
- John Segna, P.E., F.ASCE
- Elizabeth Wheeler, P.E., M.ASCE
- Andrew Kline, EIT, AM.ASCE (Corresponding Member, Younger Member Rep)
- Danielle Schroeder, P.E., M.ASCE (Corresponding Member, Communications Lead)
- Nancy Berson, Aff.M.ASCE (Staff Contact)

INSIDE THIS ISSUE:

[Meet your Governors](#)

[Letter from your Director](#)

[Spotlight Feature: Pat Sullivan](#)

[Student Chapter Highlight of the Month: Penn State Harrisburg](#)

[2024: A Tale of Two Region 2 Assemblies](#)

[Upcoming Events](#)

[Society: President-Elect visits Lehigh Valley Section](#)

The current edition of the ASCE Region 2 Ally Newsletter can be found [HERE](#).

SPONSORS - Please Read

Thank you to our current sponsor firms! Do you have employees who are not members of ASCE? Would you like to get them involved and interested in networking with colleagues, students, and

participate in social activities? Please consider bringing them with you to our next dinner meeting. ASCE Central PA will pick up the RSVP cost for them to attend and see what all ASCE has to offer.





5 FREE DOWNLOADS

ASCE Member Yearly Article Pack ➤

ASCE members now receive five free article downloads from the ASCE Library each year (except standards).

Job Postings from Our Sponsors

Click [here](#) to see more details at the ASCE Central PA Section website.



AECOM Delivering a better world



ARRO

You Live Our Work

*From sustaining **water resources**, to supporting **public infrastructure**, to **zoning** and **transportation**, ARRO has been strengthening and protecting communities since 1946.*

communications@arroconsulting.com | 717.569.7021

Your Partner.
Creating Pennsylvania's **Future.**





GRL
Engineers, Inc.

Dynamic Load Testing and Monitoring for Offshore Wind

grlengineers.com
610-459-0279



menard

Ground Improvement Specialists

<p>Pittsburgh Office Miranda Słomkowski Regional Sales Manager 412-620-6174</p>	<p>Philadelphia Office Andy Donaghy Regional Sales Engineer 215-974-2660</p>
--	---

Buildings | Ports & Airports | Rail & Road | Process & Energy

www.menardusa.com



NEWELL TERESKA & MACKAY
ENGINEERING

- Hydrology & Hydraulics
- Environmental
- Stormwater Management
- Bridge Design & Inspection
- Transportation Services
- Civil/Site Services
- Technical Training & Course Development

www.ntmeng.com



MOVING FORWARD TOGETHER®

TPD

An ENR 500 Top Design Firm serving the eastern United States since 1989

TPDinc.com



Central PA ASCE
P.O. Box 337
Camp Hill, PA 17011

<https://sections.asce.org/central-pennsylvania/>

[UNSUBSCRIBE](#)

